

Clutch Pedal Noise

Vehicle Type: **911 Carrera (996), 911 Carrera 4 (996)**

Model Year: **As of 1999 (X)**

Concern: **Noises during actuation of the clutch pedal.**

Information: When operating the clutch pedal, various types of noises may occur. When diagnosing the noise, leave the drivers door open. This will allow you to detect any noises that may be external in nature.

Work Procedure: **Scratching or scraping noise.**

Cause: The clutch pedal reinforcing rib rubs on the bracket (see arrow in figure 1). This noise is only slightly audible.

Repair: Remove the clutch pedal and rework the reinforcing rib with a file.

Note: A clutch pedal with modified reinforcing ribs has been introduced into production as of the following VIN's:

- 99 2YS 62 7327 Coupe
- 00 0YS 65 0065 Cabriolet

Squeaking noise.

Cause: The clutch pedal power assist spring rubs against the spring casing.

Repair: Replace the clutch spring with a new contoured version clutch spring (see arrow in figure 2).

Part Number	Description
996 423 081 12	New contoured version spring
996 423 081 11	Old version spring

Note: A new contoured version clutch spring was installed in production as of the following VIN's:

- 99 3YS 62 0534 Coupe
- 99 1YS 65 0950 Cabriolet

Clicking noise – To repair the clicking noise, follow steps 1 to 3 in sequence.

Step 1:

Cause: Insufficient lubrication of the ball socket in the clutch master cylinder.

Repair: Spray the ball socket in the master cylinder with spray lubricant (figure 3). If this does not eliminate the noise, continue with step 2.

Part Number	Description
000 043 204 40	New/Spray lubricant

Note: As from October 1, 1999 the master cylinder has been modified in the area of the ball socket.

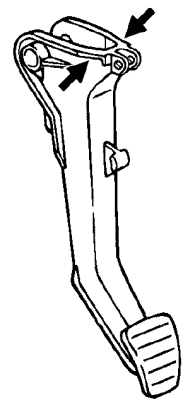

Figure 1

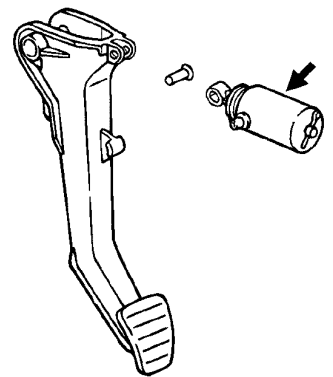

Figure 2

Work Procedure: **Step 2:**

Cause: The spring of the boost spring brushes against the spring casing (see also squeaking).

Repair: Install a new contoured version clutch assist spring. If this does not eliminate the noise, continue with step 3.

Step 3:

Cause: A shoulder may be worn into the clutch pedal reinforcing rib from rubbing on the bracket (see scratching / scraping).

Repair: Replace the clutch pedal with a new version with a modified reinforcing rib.

Part Number	Description
996 423 139 10	New version pedal
996 423 139 09	Old version pedal, no longer available

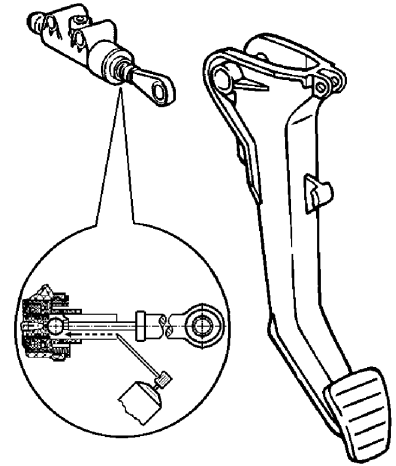

Figure 3

Literature:

911 Carrera (996) Technical Manual, Group 3, Manual transmission:
 Technical Information: 1/99 – Boost spring and clutch pedal
 Repair: 30 – Boost spring: Allocation and grease specification
 30 05 19 – Removing and installing the clutch pedal

Important Notice: Porsche Cars N.A Technical Bulletins are intended for use by professional technicians, not a "Do-it-yourselfer." They are written to inform these technicians of conditions that may occur on some vehicles, or to provide information that could assist in the proper service of a vehicle. Special tools may be required to perform certain operations identified in these bulletins. Use of tools and procedures other than those recommended in these bulletins may be detrimental to the safe operation of your vehicle. Properly trained technicians have the equipment, tools, safety instructions and know-how to do a job properly and safely. If a condition is described, do not assume that the bulletin applies to your vehicle, or that your vehicle will have that condition. See your Porsche Dealer for information on whether your vehicle may benefit from the information. Part numbers listed in these bulletins are for reference only. Always check with your authorized Porsche dealer to verify correct part numbers.

©2000 Porsche Cars North America, Inc.

Dealership	Service Manager	_____	Shop Foreman	_____	Service Technician	_____	_____	_____	_____
Distribution	Asst. Manager	_____	Warranty Admin.	_____	Service Technician	_____	_____	_____	_____
Routing									

Porsche, the Porsche marque, Carrera, Boxster, Tiptronic, VarioCam, VarioRam, Tequipment and PCM are registered trademarks. The 911 and the distinctive shapes of the Porsche automobiles are trademarks of Dr. Ing. h.c.F. Porsche AG.